



103b Norwood Road | London | SE24
9AE

Freehold

£850,000

- Beautiful Victorian cottage
- 3 bedrooms
- Through lounge
- Stylish kitchen
- Additional playroom / office
- Glass walkway
- Courtyard garden
- Off street parking
- Opposite Brockwell Park
- Herne Hill Station



Large three bedroom house, opposite Brockwell Park with it's Lido and gym, very close to Heme Hill Station and the farmer's market. A pretty front garden with rose arch leads up to the Victorian property. Through lounge, with open plan kitchen / entertaining space. Modern, light glass walkway, beside a stylish, decked courtyard garden, leading to a large reception room / self contained bedroom. First floor bathroom and additional ground floor WC. There is vehicular access to the rear and a garage! Chain free.

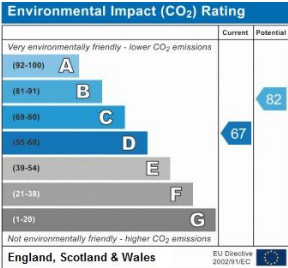
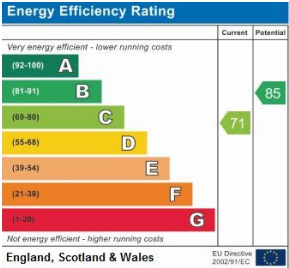

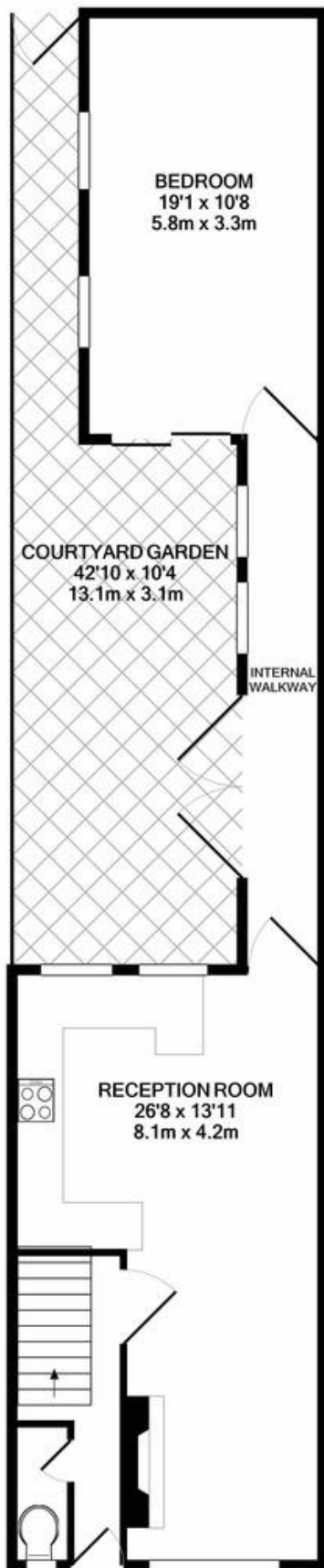

GROUND FLOOR
APPROX. FLOOR
AREA 661 SQ.FT.
(61.4 SQ.M.)

TOTAL APPROX. FLOOR AREA 1031 SQ.FT. (95.8 SQ.M.)

Whilst every attempt has been made to ensure the accuracy of the floor plan contained here, measurements of doors, windows, rooms and any other items are approximate and no responsibility is taken for any error, omission, or mis-statement. This plan is for illustrative purposes only and should be used as such by any prospective purchaser. The services, systems and appliances shown have not been tested and no guarantee as to their operability or efficiency can be given
Made with Metropix ©2021

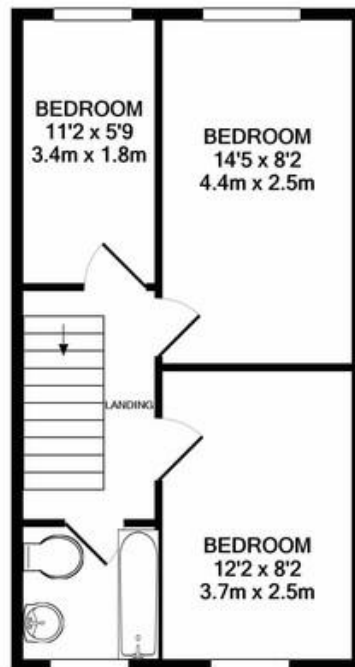

1ST FLOOR
APPROX. FLOOR
AREA 370 SQ.FT.
(34.4 SQ.M.)